

## Recycling Tips

from Julie Jackson, Allied Waste

Julie Jackson, recycling analyst with Allied Waste, sent some tips on recycling on campus-specifically, how to separate office paper and what items can be recycled in the commingle recycle cans.

1. Recycle office paper separately from the other commingled recycling. Office paper can include white and pastel including post-its in those colors. NCR forms can also go in the office paper. The light canary colors are considered pastel.

2. Paper with stickers and windows can be recycled, but Allied prefers the stickers stay out of the straight office paper recycle. Windowed envelopes can go in either the office paper or mixed recycling.

3. Commingled recycling can contain: mixed paper, newspaper, paper bags, wrapping (no metallic), paperboard (cereal boxes), magazines, phone books, any of the papers that go in the office paper, cardboard, aluminum cans, pie-type pans, clean foil, tinned cans, plastic bottles, jugs, tubs and jars.

For the most part, you can disregard the numbers on the bottom of the containers because those numbers just tell the basic resin type. There are so many formulas that the number doesn't mean much anymore.

The reason Allied prefers to have office paper separated from the commingled recycling is that by presorting it, a cleaner, higher quality paper is sent to be recycled back into high grade paper again. High-grade paper is made from long fibers, which office paper has, and is primarily made only with paper sorted this way.

Paper fibers get shorter each time they are recycled until they are so short that they fall out of the process because they no longer bond to the other fibers.

For example; if white computer paper is mixed with newspaper it will be recycled into paper bags or newsprint or some other lower quality paper. It's like wasting that high quality fiber.

Allied Waste's recycling product list is determined by the sorting facility that it is contracted with. These facilities accept commodities that have a ready market, basically that someone wants to recycle into a new product. Just because the process exists to recycle a product, doesn't mean that anyone wants it or will recycle it. It's really just like any other commodity, there has to be a market or it has no value. Some products would actually require more energy and resources to recycle than to make new.

Julie Jackson

Recycling Analyst/Promotion Specialist

Allied Waste of Albany-Lebanon & Corvallis



continued from front page . . .

now to insure that Oregonians who want to work have the skills to meet industry demands." She went on to say she is deeply disappointed on behalf of community colleges but truly worried that a budget this meager undercuts the ability of the colleges' business partners and communities to become prosperous.

The governor took the first step toward meeting community college needs by proposing an appropriation of \$483 million in his recommended budget. Community college representatives appreciated the effort to increase the fund but recognized that at the governor's number, some of the colleges would still be cutting budgets and raising tuition.

Colleges have been cutting budgets, eliminating programs and laying off employees for the last six years. This year, with state revenues at record highs and with support from businesses across Oregon, community colleges had anticipated funding that marked a real investment in workforce training.

The co-chairs' budget, which supposes that community colleges could get by on \$458 million, shuts the door on that opportunity. There are currently more than 350,000 students in Oregon community college.

"We recognize that this is just one step in a long political process," said Henderson. "Between now and the end of session legislators will be hearing daily from community college board members, employees, and students as well as business leaders from across Oregon. Community colleges are the quintessential team players. When industry says 'we need technicians', we train technicians. When hospitals say 'we have a grievous nursing shortage', we move heaven and earth to prepare more nurses to meet the need. We have been very clear that what Oregon's 17 community colleges must have this session, at a minimum, is \$529 million in the community college support fund. That money isn't for the institutions, it's for the students who need the skills and training to earn family wage jobs."

## Bookstore/HOWE Open House

**A ribbon cutting and open house will be held for the newly renovated bookstore and HOWE Division on Tuesday, April 24 from 3 to 4:30 p.m.**

**Drop by for refreshments and tour the new digs!**

The Insider is published monthly by the Marketing Department (no issues in December, July or August).

Send all inquiries, story ideas, honorable mentions, department or division achievements or awards, suggestions or feedback to:

Lori Fluge-Brunker, Publications Assistant, Insider editor  
917-4411

or

Marlene Propst, Director, College Advancement  
917-4784.

# The Insider

LINN-BENTON COMMUNITY COLLEGE STAFF NEWSLETTER

April  
2007

## Joint Ways and Means Co-Chairs Reduce Community College Funding

Co-chairs of the Joint Ways and Means Committee released their version of a budget for the 2008–2009 biennium that would effectively prevent Oregon's community colleges from providing the skilled workforce necessary to stabilize the Oregon's economy.

Locally, administrators, faculty and students voiced disappointment in the co-chairs' proposed budget. President Rita Cavin noted, "The co-chairs' recommended budget ignores the needs of our local businesses and asks our students to delay completing their educational goals. This is very bad news for all of Oregon's community colleges."

The Oregon Community College Association has asked to have a large number of LBCC supporters attend a public hearing of the Ways and Means Committee of the Oregon Legislature to show concern over the proposed budget. The hearing will be held on Tuesday, April 10 at 6:30 p.m. in the Cheldelin Middle School Cafeteria, 987 NE Conifer in Corvallis.

The committee is inviting testimony on the proposed state budget developed by the committee's co-chairs. The proposed budget is \$25 million less than the governor's recommended budget and \$71 million less than the amount requested by the colleges. Furthermore, it does not provide sufficient capital resources for the new science building LBCC hopes to begin in 2008.

A higher budget figure would allow LBCC to maintain the current tuition costs for students and would increase access to classes that are currently full.

The co-chairs' proposed budget also reduced the amount of money that the state would give to support construction efforts on community college campuses. LBCC had proposed using state construction money to build a new Science Health Center that would allow larger math, science and health occupations classes. The college has been forced to have smaller class sizes in those areas due to a lack of classroom and lab space, which has proved to be a bottleneck to students completing their degrees in a timely manner.

"Disinvesting in community colleges at this point in time makes about as much sense as ignoring the check engine light flashing on your dashboard," said Andrea Henderson, executive director of the Oregon Community College Association. "We must start training

continued on back page . . .

## Founding Board Member Passes On

Herb Hammond, one of the college's founding board members, passed away on March 19. He was one of several key community members who were instrumental in establishing LBCC.

Herb was elected to the board on Dec. 6, 1966, the same day the college was approved by Linn and Benton county voters. He served on the board until he retired in 1986. Herb served as board chairman three times, participated in the selection of three LBCC presidents, served on several state committees and was a strong advocate for vocational education.

In recognition of his years of service and dedication to the college and the community, Herb was awarded the LBCC Distinguished Service Award in 1986. His wife, Helen Hammond, received an honorary associate degree for her support of the college and for sharing Herb with LBCC and the community.

Rosemary Bennett is writing the history of the college, and we are fortunate that she was able to spend some time interviewing Herb about his memories of LBCC. Rosemary shared that Herb "kept all of his papers" from those early years and that they have been very helpful in documenting LBCC's beginnings from a community perspective.

Herb was recognized as an emeritus member of the LBCC Foundation Board in 1993. He and Helen continued to support the college and our students over the years, attending numerous Foundation events.

## Soliciting Suggestions for 40th Anniversary

During the 2007-2008 academic year, the college will celebrate its 40th anniversary.

Instead of planning one large event, we are looking for activities that could be highlighted as anniversary activities throughout the year, although one event may emerge as a main focus for the celebration.

Please email your ideas to Marlene Propst.



# Campus News and Events

## New Faces/Promotions

- **Cindy Hutchison**, Classified, replacing Stephanie Ray, Custodian, Facilities, transferred from Custodian, Facilities, effective 03/01/07.
- **Gregory King**, Classified, replacing James Burnett, Maintenance Specialist 4, Facilities, promoted from Maintenance Specialist 3, Facilities, effective 03/01/07.
- **Carol Raymundo**, Classified, replacing LeAnn Schamp, Clerical Specialist 3, Educational Partnerships, transferred from Clerical Specialist 3, Career Center, effective 03/05/07.
- **LeAnn Schamp**, Classified, replacing Susan K. Peck, Clerical Specialist 2, Admissions and Records, transferred from Clerical Specialist 3, Educational Partnerships, effective 01/22/07.
- **Lisa Sledge**, Classified, replacing Martha Foster, Early Childhood Teacher, Education/Child and Family Studies, effective 02/01/07.
- **James Wixson**, Classified, replacing Gregory King, Maintenance Specialist 3, Facilities, promoted from Maintenance Specialist 1, effective 03/01/07.

## Good-byes/Leaves of Absence

- **Rosemary Bennett**, Faculty, Counselor, Career Center, early retirement, effective 07/01/07.
- **Rich Bergeman**, Faculty, Journalism/Photography, Art, early retirement, effective 07/01/07.
- **Diana Curwen**, Faculty, ESOL, Adult Basic Skills Development, early retirement, effective 07/01/07.
- **Judith DeWaard** Classified, Program Assistant 1, Health Occupations and Workforce Education, effective 03/02/07.
- **Linda Donald**, Faculty, Parenting Education, early retirement, effective 07/01/07.
- **Ann Marie Etheridge**, Faculty, Counselor, Career Center, early retirement, effective 05/01/07.
- **Janice Huskey**, Classified, Academic Affairs Specialist, Academic Affairs, early retirement, effective 05/01/07.
- **Paul Landgren**, Classified, Equipment Mechanic, Facilities, early retirement, effective 07/01/07.
- **William Schrempp**, Faculty, Training Specialist, HOSEC, effective 06/30/07.

## What's Happening

- **Thursday, April 12, AAWCC meeting, Ya' Gotta Love It, noon to 1 p.m., Boardrooms.** Join in as Rita Cavin discusses leadership in this thought-provoking and enlightening presentation. Lunch of soup and roll is provided for members of AAWCC and can be purchased by non-members for \$2.75.
- **Wednesday, April 18, Global Warming Presentation, noon to 2 p.m., Forum 104.** Secretary of State Bill Bradbury will give a presentation addressing the climate change crisis. He has worked closely with Al Gore, and he will use parts of Gore's slide show along with local slides showing the steps Oregon and other states in the Pacific Northwest are taking to curtail global warming. Contact SL& L for more information.

• **Sunday, April 22, Travel at the Tripp "Isreal Today", 2 p.m., Russell Tripp Performance Center.** Join filmmaker Fran Reidelberger on a trip through the holy place of Christianity, Islam and Judaism that is Israel today, visiting many sites along the way. Ticket prices are \$7 for each show, \$6 for students/seniors. For more information or to purchase tickets, contact the Performance Center box office at 917-4531.

• **April 23-27, Violence Prevention Week,** This week-long observance is aimed at providing helpful information and discussion on ways we can help prevent violence. Daily activities throughout the week will culminate in the Clothesline Project, a display that bears witness to violence against women. To participate in the project or for more information on activities, contact LBCC Student Ambassador JoDee Lonsdale at 917-4457.

• **Wednesday, April 25, Classified Appreciation Luncheon, 11:30 a.m. to 1 p.m., Commons.** Mark the date for our classified lunch. This year's theme is Classified Staff: You Make Magic! The evening crew will be honored that evening, and the centers will have individual celebrations. Brought to you by the Classified Appreciation Planning Committee.

• **Wednesday, April 25, 7th annual International Dinner: Scottish Food and Folklore, 6 to 8 p.m., Commons.** This year's theme is Scotland and features traditional Scottish food, dancing, a bagpiper, a fiddler and Scottish souvenirs. Tickets are \$7 for LBCC students and \$10 for all others. RSVP to the SL & L office at ext. 4457 to reserve your seat. Tickets will be sold at the door and are limited to the first 250 guests.

• **Thursday, April 26, Take Your Child to Work Day, 11 a.m. to 1 p.m., Alesa/Calapooia Room.** Employees of LBCC are invited to bring their children to work and participate in a program designed especially for them. It will feature men and women who work in exciting careers unusual for their gender. Each will talk about what they do and why they chose their career. Games will be played and there will be wonderful door prizes. Free lunch will be provided. This event is sponsored by the LBCC Non-Traditional Careers Program.

• **Saturday, April 28, 3rd Annual Powwow, 3 p.m., Activities Center.** This free event features Native American dancing and drumming along with food and fun. Grand Entry at 5 p.m. with Nick Sixkiller, education coordinator for the Siletz tribe. For more information, contact the Multicultural Center.



## Bookstore Correction

Last month's issue had an incorrect number for the amount of square footage added to the bookstore during the recent renovation. An additional 4,300 square feet was added (not 1,800 square) to the 3,600-square-foot area, bringing the total square footage of the bookstore to 7,900 square feet.

## Interim Board Members Appointed

The LBCC Board of Education appointed two interim board members, Elaine Eastman and Doug Isaac, to fill vacancies for Zones 2 and 3.

Eastman is president and CEO of Central Willamette Credit Union, and Isaac is manufacturing manager at Synthetech, Inc. The two will jointly serve both zones, which cover North and West Linn County.

The vacancies were created by the resignation in November of board member Joseph Novak and the unexpected death in February of board chair Wes Price.

Eastman and Isaac were sworn in by Judge Jim Goode at the March Board of Education meeting. They will serve until the end of June. New board members are expected to be elected May 15 and take office July 1.

Eastman is a Brownsville native who graduated with honors from the Western Credit Union National Association Management School. She has served on the LBCC Budget Committee and the Linn County Compensation Committee, and as a volunteer in many other community organizations.

Isaac graduated summa cum laude in business management from Oregon State University. He is chair of the Albany Rural Fire District.

Due to Eastman's board appointment, she resigned her position on the college budget committee. Richard Running, a local certified public accountant, was appointed to fill that position.

Running holds an undergraduate degree from Pacific Lutheran University and a master's from the University of Denver. He is active in Rotary and has been involved with United Way of Linn County and the Albany Chamber of Commerce.



Doug Isaac, left, and Elaine Eastman are sworn in as interim board members by Albany Judge Jim Goode during the Board of Education meeting held March 21. Isaac and Eastman will hold the interim positions for Zones 2 and 3 until new board members from the May elections take over July 1.



**"Good teaching is one-fourth preparation and three-fourths theater."**

- Gail Godwin, author



## Library Moving to Temp Location

The Library and Learning Center will be moving to temporary locations in June in preparation for upcoming renovation. The Library will be moving to IB-120. The Learning Center will be housed in several locations on campus. A complete list of locations can be found at <http://po.linnbenton.edu/capitalplanning/lcindex.html>.

The shared vision statement is to create a Library and Learning Center that supports student retention and encourages student success.

The 35-year-old facilities are in need of renovation to support new technologies and instructional needs of the growing student population. Updates to the Library will include improved lighting, aesthetic modernization, a new reading room, an enlarged library instruction room, a group study room, a commons area with computers for group work and new display areas.

The Learning Center will gain an additional 5,200 square feet. Improvements will include group study rooms, an additional computer classroom, an enlarged Reading/Writing/Study Skills Lab, a larger testing area, a larger Math 20 classroom and additional office space.

There will be a study area shared by both the Library and the Learning Center. An internal staircase and new elevator will improve student access between the two floors.

The cost of the project is currently budgeted at about \$3.3 million. An anonymous donation to the Library of \$1.5 million dollars was designated to help with renovation costs.

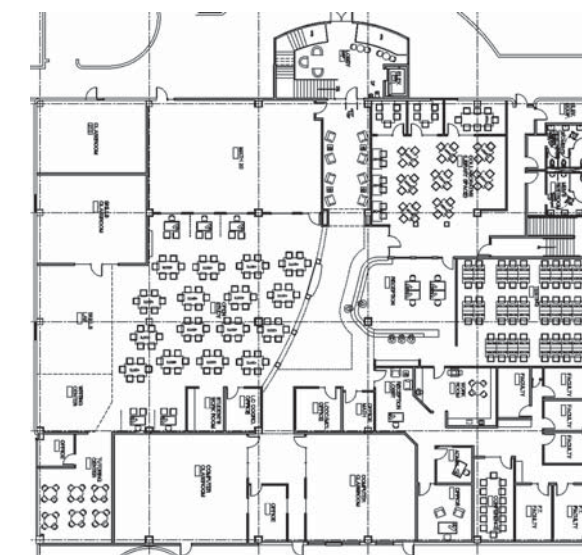

Conceptual drawing of the Library and floorplan.